

SWISS INSTITUTE / CONTEMPORARY ART  
495 BROADWAY / 3RD FLOOR  
NEW YORK / NY 10012  
TEL 212.925.2035  
WWW.SWISSINSTITUTE.NET

# SI

## Under Destruction III

*Alexander Gutke, Kris Martin, Jonathan Schipper, Ariel Schlesinger, and Roman Signer*  
Curated by Gianni Jetzer and Chris Sharp

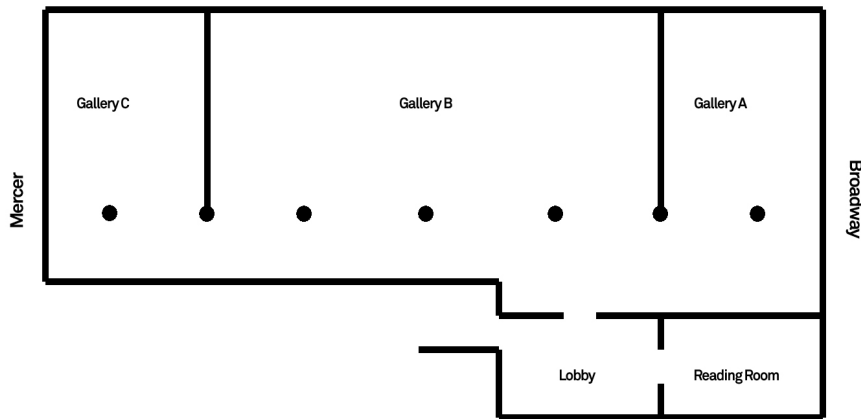

### LOBBY

Roman Signer, *Rampe*, 2008  
7' 03" looped  
Courtesy the artist

### GALLERY A

Jonathan Schipper, *To Dust*, 2009-2010  
Cement, steel, electric motor  
Courtesy the artist and Pierogi, New York

### GALLERY B

*(Clockwise, from the West wall)*

Kris Martin, *100 Years*, 2004  
Mixed media, edition 1/10  
Courtesy Private Collection

Ariel Schlesinger, *Bubble Machine*, 2006  
Gas, soap bubbles, ladder, electric drill, wood, stools, and high voltage transformer  
Courtesy Private Collection, Slovenia

### GALLERY C

Alexander Gutke, *The White Light of the Void*, 2002  
16mm film projection, looped  
Courtesy Galerija Gregor Podnar, Berlin/ Ljubljana

## Eric Andersen

# Preparation For A Miracle

*A collaboration with Cabaret Voltaire, Zurich*

Reading Room  
*(Clockwise, from the West wall)*

*Preparations Pour Un Miracle*, 2011  
Silkscreen, woodcut, and letterpress on paper  
16.8 x 23.5 inches | 42.7 x 59.7 cm

*A Loon On The Moon*, 2011  
Silkscreen, woodcut, and letterpress on paper  
Edition 45 of 50  
16.8 x 23.5 inches | 42.7 x 59.7 cm

*Ease-Loosen-Be Shrivin*, 2011  
Silkscreen, woodcut, and letterpress on paper  
Edition 35 of 50  
16.8 x 23.5 inches | 42.7 x 59.7 cm

*Preparation For A Miracle*, 2011  
Silkscreen, woodcut, and letterpress on paper  
Edition 18 of 50  
16.8 x 23.5 inches | 42.7 x 59.7 cm

*Silence Is Better Than Bullshit*, 2011  
Silkscreen, woodcut, and letterpress on paper  
Edition 12 of 50  
16.8 x 23.5 inches | 42.7 x 59.7 cm

*Frame The Words*, 2011  
Silkscreen, woodcut, and letterpress on paper  
Edition 16 of 50  
16.8 x 23.5 inches | 42.7 x 59.7 cm

*Les Compositions*, 2011  
Silkscreen, woodcut, and letterpress on paper  
Edition 47 of 50  
16.8 x 23.5 inches | 42.7 x 59.7 cm

*The Shroud Too Has Velvet Gloves*, 2011  
Silkscreen, woodcut, and letterpress on paper  
Edition 26 of 50  
16.8 x 23.5 inches | 42.7 x 59.7 cm

*Age Before Beauty*, 2011  
Silkscreen, woodcut, and letterpress on paper  
Edition 17 of 37  
16.8 x 23.5 inches | 42.7 x 59.7 cm

*Insignia Irradiated By Eclipse*, 2011  
Silkscreen, woodcut, and letterpress on paper  
Edition 25 of 50  
16.8 x 23.5 inches | 42.7 x 59.7 cm

*You*, 2011

Silkscreen, woodcut, and letterpress on paper

Edition 12 of 50

16.8 x 23.5 inches | 42.7 x 59.7 cm

*Urn*, 2011

Silkscreen, woodcut, and letterpress on paper

Edition 35 of 50

16.8 x 23.5 inches | 42.7 x 59.7 cm

*I Leave The Much To Others*, 2011

Silkscreen, woodcut, and letterpress on paper

Edition 21 of 50

16.8 x 23.5 inches | 42.7 x 59.7 cm